

▶ CHDBT-1H7CPL

1 by 8 HDMI over HDMI & CAT5e/6/7 Splitter



The HDMI over HDMI and CAT5e/6/7 Splitter can split and distribute a single HDMI input and 2-way IR control up to seven CAT5e/6/7 outputs and includes a simultaneous HDMI bypass output. It supports resolutions up to 4Kx2K timing, 3D and multi-channel digital audio formats (such as LPCM 7.1CH, Bitstream, HD Bitstream). The HDMI bypass output can be connected to an HDMI display or cascaded to another splitter. The CAT5e/6/7 outputs can be connected to HDBaseT to HDMI Receivers to extend the operating distance up to 70 meters with Power Over Cable feature.

PANELS

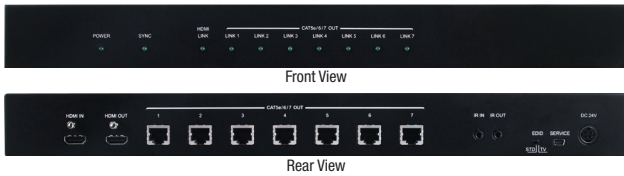

DIAGRAM

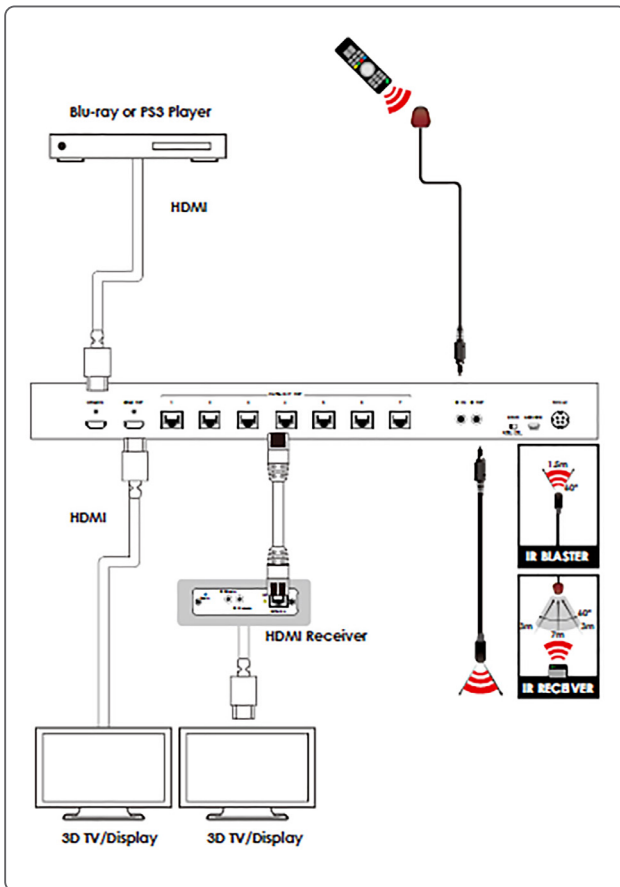

FEATURES

- Simultaneous HDMI and CAT5e/6/7 outputs
- Supports data rate from 250Mbps up to 3Gbps
- Supports up to 4096x2160@60Hz YUV 4:2:0 8bit
- Supports LPCM 7.1CH, Bitstream, HD Bitstream transmission (32-192kHz sample rate)
- Supports selection of Standard or TV EDID settings
- Supports Power over Cable (PoC) feature
- Supports Bidirectional IR control
- The 3D signal display follow by display TV's EDID

SPECIFICATIONS

Interfaces

| | |
|--------------------------|-------------------------------------|
| Input Port | 1 HDMI (Type-A) |
| Output Port | 1 HDMI (Type-A) 7 HDBaseT(RJ-45) |
| Pass-through Port | 1 IR IN (3.5mm) 1 IR OUT (3.5mm) |
| Service Port | 1 USB(Mini-B) |

Video

| | |
|---------------------------|-------------------------------|
| HDMI Compliance | 2.0a (DVI 1.0) |
| HDCP Compliance | 2.x |
| Input Signal Type | 4096x2160@60Hz YUV 4:2:0 8bit |
| Output Signal Type | 4096x2160@60Hz YUV 4:2:0 8bit |

Resolutions

| | | |
|-----------------------|---------|---------------------|
| Maximum Input | HDMI | 4096x2160p@60 4:2:0 |
| Maximum Output | HDMI | 4096x2160p@60 4:2:0 |
| | HDBaseT | 4096x2160p@60 4:2:0 |

Power

| | |
|--------------------------|---------------|
| Power Supply | 24V / 2.7A DC |
| Power Consumption | 62.7W |

Enclosure

| | |
|---------------------------|--|
| Chassis Material | Metal |
| Chassis Color | Black |
| Dimensions (WxHxD) | 432mm x 44 mm x 174 mm [Case Only] 432mm x 44 mm x 179 mm [All Inclusive] |
| Weight | 2126g |

Field Firmware Update

Mini-USB to PC

ORDERING INFORMATION

| Model No. | Product Description |
|--------------|--|
| CHDBT-1H7CPL | 1 by 8 HDMI over HDMI & CAT5e/6/7 Splitter |