

JUNIOR PR

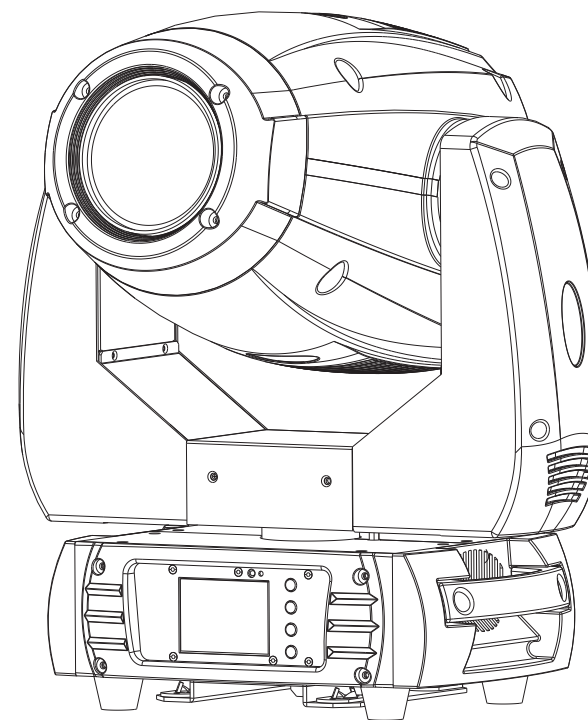

JNR MINI SPOT 250-Z
JNR-8171

PR LIGHTING LTD.
<http://www.pr-lighting.com>
1582 Xingye Avenue, Nancun Panyu
Guangzhou, 511442 China
TEL: +86-20-3995 2888

1 SAFETY INSTRUCTIONS



CAUTION

Becareful with your operations. With a dangerous voltage you cansuffer a dangerous electric shock when touching wires!

This device has left the factory in perfect condition. In order to maintain this condition and to ensure a safe operation, it is absolutely necessary for the user to follow the safety instructions and warning notes written in this user manual.



IMPORTANT

Damages caused by the disregard of this user manual are not subject to warranty. The dealer will not accept liability for any resulting defects or problems.

If the device has been exposed to temperature changes due to environmental changes, do not switch it on immediately. The arising condensation could damage the device. Leave the device switched off until it has reached room temperature.

This device falls under protection-class I. Therefore it is essential that the device be earthed.

The electric connection must carry out by qualified person.

The device shall only be used with rate voltage and frequency.

Make sure that the available voltage is not higher than stated at the end of this manual.

Make sure the power cord is never crimped or damaged by sharp edges. If this would be the case, replacement of the cable must be done by an authorized dealer.

Always disconnect from the mains, when the device is not in use or before cleaning it. Only handle the power cord by the plug. Never pull out the plug by tugging the power cord.

During initial start-up some smoke or smell may arise. This is a normal process and does not necessarily mean that the device is defective, it should decrease gradually.

Please don't project the beam onto combustible substances.

Fixtures cannot be installed on combustible substances, keep more than 50cm distance with wall for smooth air flow, so there should be no shelter for fans and ventilation for heat radiation.

If the external flexible cable or cord of this luminaire is damaged, it shall be exclusively replaced by the manufacturer or his service agent or a similar qualified person in order to avoid a hazard.

10 MAINTENANCE AND CLEANING

The following points have to be considered during the inspection:

- 1) All screws for installing the devices or parts of the device have to be tightly connected and must not be corroded.
- 2) There must not be any deformations on the housing, color lenses, fixations and installation spots (ceiling, suspension, trussing).
- 3) Mechanically moved parts must not show any traces of wearing and must not rotate with unbalances.
- 4) The electric power supply cables must not show any damage, material fatigue or sediments.

Further instructions depending on the installation spot and usage have to be adhered by a skilled installer and any safety problems have to be removed.



In order to make the lights in good condition and extend the life time, we suggest a regular cleaning to the lights.

- 1) Clean the inside and outside lens each week to avoid the weakness of the lights due to accumulation of dust.
- 2) Clean the fan each week.
- 3) A detailed electric check by approved electrical engineer each three month, make sure that the circuit contacts are in good condition, prevent the poor contact of circuit from overheating.

We recommend a frequent cleaning of the device. Please use a moist, lint- free cloth. Never use alcohol or solvents.

There are no serviceable parts inside the device. Please refer to the instructions under "Installation instructions".

Should you need any spare parts, please order genuine parts from your local dealer.

2 UNPACKING

Thank you for choosing our JNR MINI SPOT 250-Z. For your own safety, please read this manual before installing the device. This manual covers the important information on installation and applications. Please install and operate the fixture with following instructions. Meanwhile, please keep this manual well for future needs.

The JNR MINI SPOT 250-Z is made of a new type of high temperature strength of engineering plastics and cast aluminum casing with nice outlook. The fixture is designed and manufactured strictly following CE standards, complying with international standard DMX512 protocol. It's available independently controlled and linkable with each other for operation. And it is applicable for large-scale live performances, theater, studio, nightclubs and discos.

The JNR MINI SPOT 250-Z adopts a 250W white LED lamp which features high brightness and stability. Please carefully unpack it when you receive the fixture and check whether it is damaged during the transportation. And please check whether the following items are included inside the box:

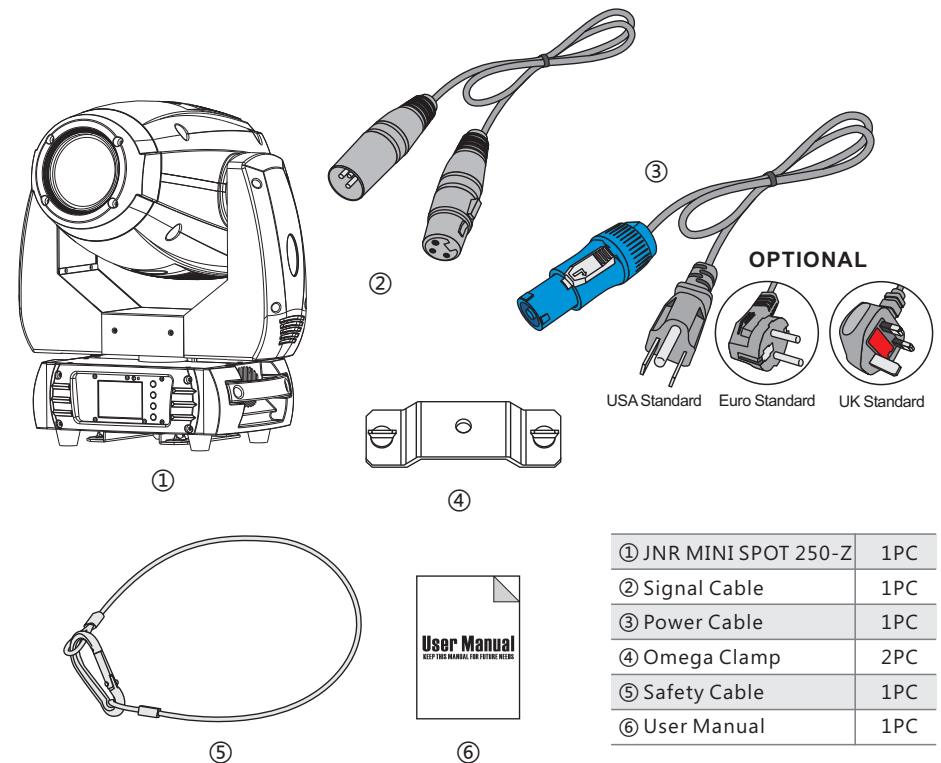

① JNR MINI SPOT 250-Z	1PC
② Signal Cable	1PC
③ Power Cable	1PC
④ Omega Clamp	2PC
⑤ Safety Cable	1PC
⑥ User Manual	1PC

3 FEATURES & SPECIFICATIONS

Features

- A 250W white LED lamp, 7500K
- 50000 hours life span and low power consumption
- 8/16 bit smooth and precise resolution for PAN/TILT movement
- 540°/630°/ 360°PAN and 270°/180°/90° TILT movement
- Scan position memory, auto reposition after unexpected movement
- Smooth linear motorized zoom ranging from 11°-23°
- Specific high precision glass optic system
- 1 Rotating gobo wheel with 6 rotatable and interchangeable gobos plus open (3 glass gobos and 3 metal gobos with speed adjustable, stream effect, dithering effect and rotatable clockwise or anticlockwise)
- Gobo indexing available
- Gobo size 22.9mm (external dimensions)/16mm (inner dimensions)
- 1 Static gobo wheel with 8 gobos plus open
- Gobo overlay (gobo morphing)
- 1 Color wheel with 7 colors plus open (available for half color mode)
- Variable direction rainbow effect with speed adjustable
- Gobo time and color time controllable
- 2.5M-15M electric focus
- 3-Facet prism with variable speed and direction
- 0-100% Smooth linear LED dimmer (2 dimmer modes)
- 25T/sec high speed LED shutter/strobe effect with variable speed
- Preset variable/random strobe and dimming pulse effect
- Frost filter (Hybrid effect for wash)
- 14/16/18 DMX channels USITT DMX-512 (Vector mode 18CH)
- DMX512, master-slave, and sound activated controllable or auto operation(7 built-in programs)
- DMX recorder and edit function integrated
- Sound control with sensitivity adjustment
- 2.4" TFT LCD display (320*240pix) with 4 control buttons
- 180° Reversible for LCD display
- LCD display switch-off automatically after 60 seconds
- DMX signal monitoring indicator available
- Lower noise and efficient FAN cooling system
- Efficient low noise self adjusting fan cooling system
- Constant temperature readout and management function
- Over heat protection management
- Powercon IN/ OUT with power switch and fuse
- 3-Pin DMX connectors IN/OUT
- DB rating@1M=54.18dB
- IP20 protection rating
- -35°C to 45°C ambient temperature
- 2*1/4 turn fastening Omega Clamps (Adaptable vertically and horizontally)
- 1*Safety attachment point
- CE (EMC/LVD) and RoHS certified

12	10	12	Zoom	0-255	In(near)to out (far)
13	11	13	Rotation prism	0-5	OFF
				6-127	ON
				128-189	Forwards rotation from fast to slow
				190-193	Prism rotation stop
14	12	14	Frost	194-255	Frowards rotation from fast to slow
				0-199	Frost OFF
15	13	15	Speed Pan/Tilt	200-255	Frost ON
				0-255	Max to min speed
				226-235	Blackout by movement
16	14	16	Special function	236-245	Blackout by all wheel changing
				246-255	No function
				0-79	No function
				80-84	All motor reset
				85-87	Scan motor reset
				88-90	Colors motor reset
				91-93	Gobo motor reset
				94-96	Shutter&Dimmer motor reset
				97-99	Other motor reset
				100-119	Internal program 1
				120-139	Internal program 2
				140-159	Internal program 3
				160-179	Internal program 4
				180-199	Internal program 5
200-219	Internal program 6				
220-239	Internal program 7				
		17	Color Time	0-255	Max to min speed
		18	Gobo Time	0-255	Max to min speed

				40-49	Gobo 4
				50-59	Gobo 5
				60-69	Gobo 6
				70-89	Gobo 1 shake slow to fast
				90-109	Gobo 2 shake slow to fast
				110-129	Gobo 3 shake slow to fast
				130-149	Gobo 4 shake slow to fast
				150-169	Gobo 5 shake slow to fast
				170-189	Gobo 6 shake slow to fast
				190-255	Rot.gobo wheel cont.rotation slow to fast
7	5	7	Gobo1 rotation	0-127	Gobo indexing
				128-189	Forwards gobo rotation from fast to slow
				190-193	Gobo rotation stop
				194-255	Backwards rainbow effect from slow to fast
8	6	8	Gobo wheel 2	0-9	Hole with spot
				10-19	Gobo 1
				20-29	Gobo 2
				30-39	Gobo 3
				40-49	Gobo 4
				50-59	Gobo 5
				60-69	Gobo 6
				70-79	Gobo 7
				80-89	Gobo 8
				90-101	Gobo 1 shake slow to fast
				102-113	Gobo 2 shake slow to fast
				114-125	Gobo 3 shake slow to fast
				126-137	Gobo 4 shake slow to fast
				138-149	Gobo 5 shake slow to fast
				150-161	Gobo 6 shake slow to fast
				162-173	Gobo 7 shake slow to fast
				174-185	Gobo 8 shake slow to fast
				186-255	Gobo wheel rotation from slow to fast
9	7	9	Shutter	0-31	Shutter closed
				32-63	Shutter open
				64-95	Strobe effect slow to fast
				96-127	Shutter open
				128-159	Pulse-effect in sequences slow to fast
				160-191	Shutter open
				192-223	Random strobe effect slow to fast
				224-255	Shutter open
10	8	10	Dimmer	0-255	Dimmer0%...100%
11	9	11	Focus	0-255	In(near)to out(far)

Specifications

Input Voltage: AC90-260V 50/60Hz

LED Quantities: 1*250W 7500K white LED

Control Signal: DMX512, master-slave and sound activated or auto operation

Control Channel: 14/16/18 DMX channels USITT DMX-512

Power Consumption: 290W

Dimensions: 367(D)*203(W)*505(H)mm

Packing Dimensions: 445(D)*400(W)*515(H)mm

Net Weight: 14kg

Gross Weight: 16.8kg

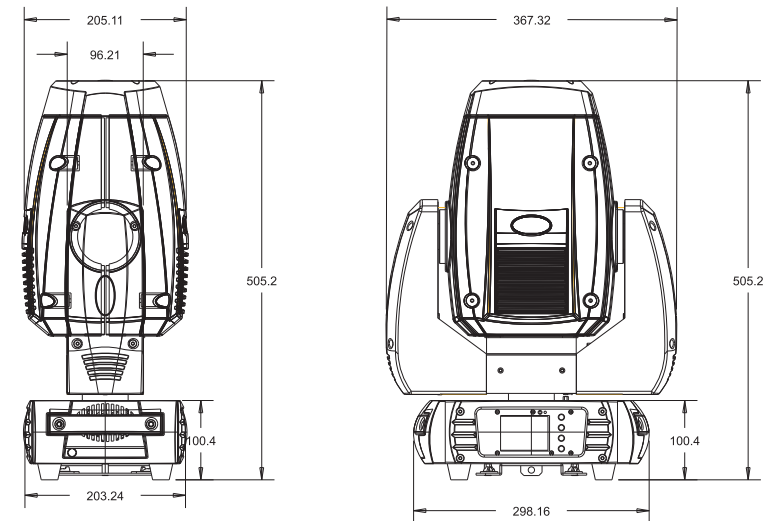

Rotating gobos

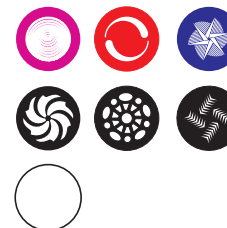

Static gobos

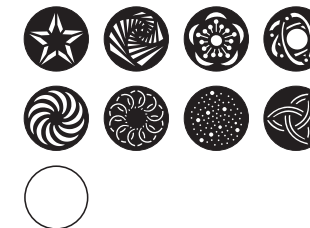

Colors

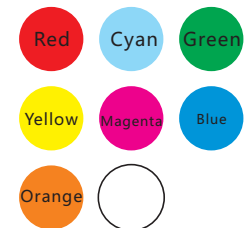

4 PHOTOMETRIC DATA

Photometric Beam Angle Data 11°~23° Beam Angle LUX × 0.0929=FC

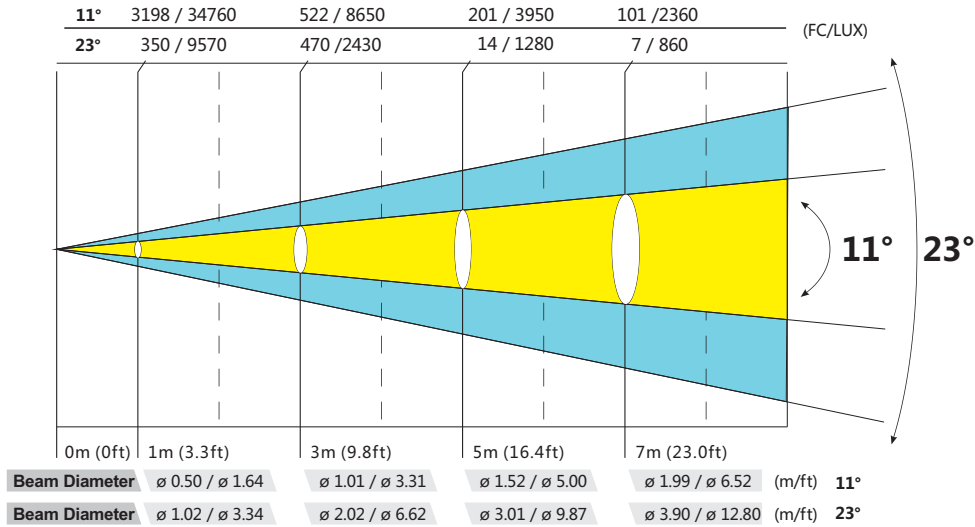

5 OPERATION INSTRUCTIONS

- The JNR MINI SPOT 250-Z is for beam effect for on-site decoration purpose.
- Don't turn on the fixture if it's been through severe temperature difference like after transportation because it might damage the light due to the environment changes. So make sure to operate the fixture until it is in normal temperature.
- This light should be keep away from strong shaking during any transportation or movement.
- Don't pull up the light by only the head, or it might cause damages to the mechanical parts.
- Don't expose the fixture in overheat, moisture or environment with too much dust when installing it. And don't lay any power cables on the floor. Or it might cause electronic shock to the people.
- Make sure the installation place is in good safety condition before installing the fixture.
- Make sure to put the safety chain and check whether the screws are screwed properly when installing the fixture.
- Make sure the lens are in good condition. It's recommended to replace the units if

9 DMX CHANNELS

Mode/Channel	Function	Values	Description		
16b	8b	EX			
1	1	1	PAN		
0-255			PAN movement		
2		2	PAN-fine		
0-255			Fine control of PAN movement		
3	2	3	TILT		
0-255			TILT movement		
4		4	TILT-fine		
0-255			Fine control of TILT movement		
5	3	5	Color wheel1	0-15	Open / White
				16-31	Color 1
				32-47	Color 2
				48-63	Color 3
				64-79	Color 4
				80-95	Color 5
				96-111	Color 6
				112-127	Color 7
				128-189	Forwards rainbow effect from fast to slow
				190-193	Color rotation stop
194-255	Backwards rainbow effect from slow to fast				
5	3	5	Color wheel (Mode 2)	0-7	Open / White
				8-15	White+Color 1
				16-23	Color 1
				24-31	Color 1+Color 2
				32-39	Color 2
				40-47	Color 2+Color 3
				48-55	Color 3
				56-63	Color 3+Color 4
				64-71	Color 4
				72-79	Color 4+Color 5
				80-87	Color 5
				88-95	Color 5+Color 6
				96-103	Color 6
				104-111	Color 6+Color 7
				112-119	Color 7
120-127	Color 7+White				
128-189	Forward rainbow effect from fast to slow				
190-193	Color rotation stop				
194-255	Backward rainbow effect from slow to fast				
6	4	6	Gobo1 Wheel	0-9	Open
				10-19	Gobo 1
				20-29	Gobo 2
				30-39	Gobo 3

8 MENU OPERATIONS

MENU	Function Mode	Dmx Address	A001-AXXX		DMX address setting
		Channel Mode	CH16		Standard channel
			Ch14		Vector channel
			CH18		Extend channel
		Auto Run	Internal Program 1~8	Master/Alone	Alone Mode
	Music Control	Internal Program 1~8	Master/Alone	Sound Mode	
	Option	Reset Default	Yes/No		Overloading factory all parameters
		Signal Set	Wire DMX		Wire DMX Input
			Wireless DMX		Wireless DMX Input
			Act WDMX & Out		Wireless DMX input, Wire DMX output signal at the same time
		Pan/Tilt	Reverse Pan (On/Off)		Pan scan reverse
			Reverse Tilt (On/Off)		Tilt scan reverse
			Select Pan 630°/540° /360°		Pan angle select
			Select Tilt 270°/180°/90°		Tilt angle select
		UI SET	Mic sensitivity 0~99%		Mic sensitivity Setting
			OFF Signal Mode (On/Off)		No DMX signal, Keep the original State(No)Reset state
	Half Color Wheel(On/Off)		Start half the color function		
	Information	Temperature	XXX°C/°F		Current temperature
		Software Version	V1.1~v9.9		Software version
	Manual Control	Reset	Total Reset		Reset all
Pan/Tilt Reset			Pan/Tilt reset		
Color Reset			Color Reset		
Gobo Reset			Gobo Reset		
The Others Reset			Other Reset		
Channel	PAN=XXX.....		Channel value control		
ADVANCED (Access Code 088)	Calibration	PAN=XXX.....		Calibration Function	

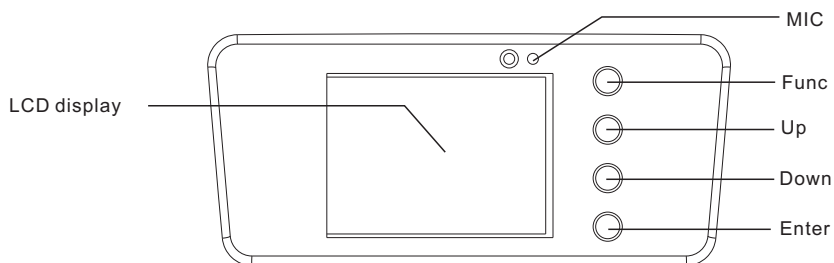

- there are any damages or severe scratch.
- Make sure the fixture is operated by qualified personnel who knows the fixture before using.
- Keep the original packages if any second shipment is needed.
- Don't try to change the fixtures without any instruction by the manufacturer or the appointed repairing agencies.
- It is not in warranty range if there are any malfunctions from not following the user manual to operate or any illegal operation, like shock short circuit, electronic shock, lamp broke, etc.

6 INSTALLATIONS

Cautions: For added protection mount the fixtures in areas outside walking paths, seating areas, or in areas where the fixture might be reached by unauthorized personnel.

Before mounting the fixture to any surface, make sure that the installation area can hold a minimum point load of 10 times the device's weight.

Fixture installation must always be secured with a secondary safety attachment, such as an appropriate safety cable.

Never stand directly below the device when mounting, removing, or servicing the fixture.

from a ceiling, or set on a flat level surface (see illustration below). Be sure this fixture is kept at least 0.5m (1.5 ft) away from any flammable materials (decoration etc.).

Always use and install the supplied safety cable as a safety measure to prevent accidental damage and/or injury in the event the clamp fails.

Mounting points: Overhead mounting requires extensive experience, including amongst others calculating working load limits, a fine knowledge of the installation material being used, and periodic safety inspection of all installation material and the fixture. If you lack these qualifications, do not attempt the installation yourself. Improper installation can result in bodily injury.

Be sure to complete all rigging and installation procedures before connecting the main power cord to the appropriate wall outlet.

Clamp mounting: The JNR MINI SPOT 250-Z provides two unique mounting bracket assembly that integrates the bottom of the base, the included "Omega Bracket," and the safety cable rigging point in one unit (see the illustration below). When mounting this fixture to truss be sure to secure an appropriately rated clamp to the included omega bracket using a M10 screw fitted through the center hole of the "omega bracket". As an added safety measure be sure to attached at least one properly rated safety cable to the fixture using on of the safety cable rigging point integrated in the base assembly.

Regardless of the rigging option you choose for your JNR MINI SPOT 250-Z, always be sure to secure your fixture with a safety cable. The fixture provides a built-in rigging point for a safety cable on the hanging bracket as illustrated above. Be sure to only use the designated rigging point for the safety cable and never secure a safety cable to a carrying handle.

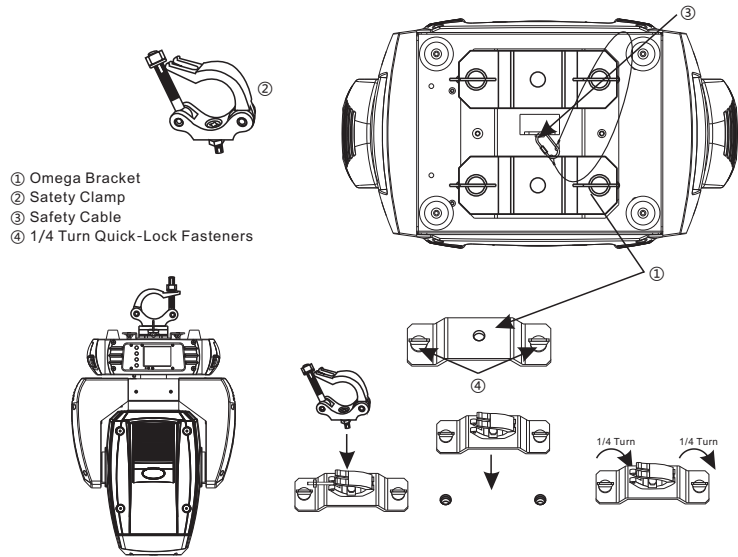

- ① Omega Bracket
- ② Safety Clamp
- ③ Safety Cable
- ④ 1/4 Turn Quick-Lock Fasteners

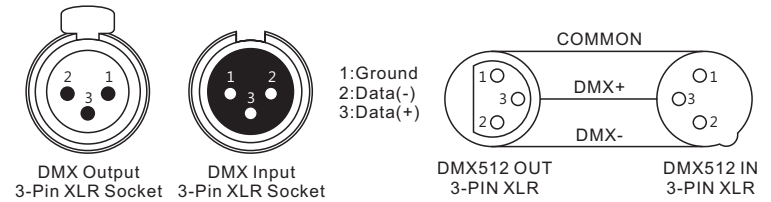
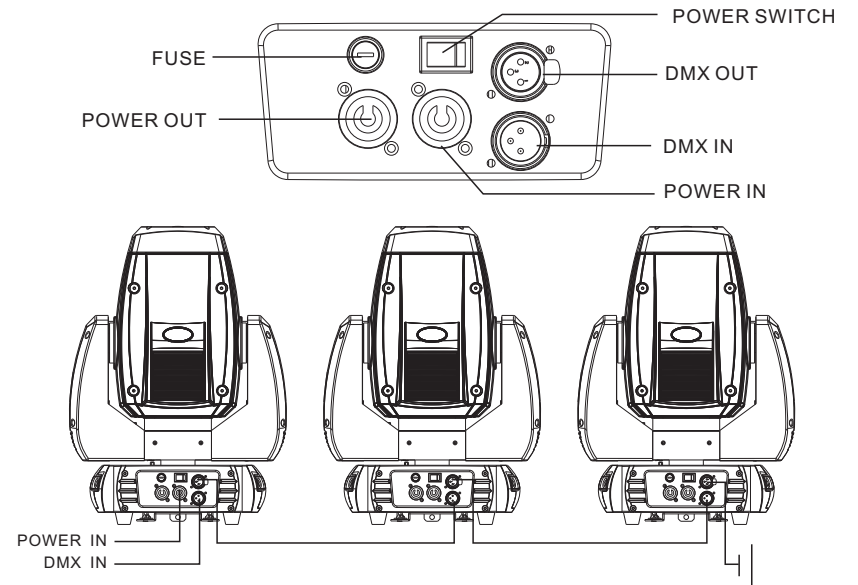

! **If you connect fixtures to AC power in a linked chain, please do not link more than:**

1. Three(3) fixtures at 100-120VAC, 50/60Hz.
2. Four(4) fixtures at 200-240 V, 50/60Hz.

7 DMX-512 CONTROL CONNECTIONS

Connect the provided XLR cable to the female 3-pin XLR output of your controller and the other side to the male 3-pin XLR input of the moving head. You can chain multiple Moving head together through serial linking. The cable needed should be two core, screened cable with XLR input and output connectors. Please refer to the diagram below.

DMX-512 connection with DMX terminator

For installations where the DMX cable has to run a long distance or is in an electrically noisy environment, such as in a discotheque, it is recommended to use a DMX terminator. This helps in preventing corruption of the digital control signal by electrical noise. The DMX terminator is simply an XLR plug with a 120 Ω resistor connected between pins 2 and 3, which is then plugged into the output XLR socket of the last fixture in the chain. Please see illustrations below.

