

LARK 150

Quick Start Guide

V1.0.0

Contents

- LARK 150 1
 - Quick Start Guide 1
- INTRODUCTION 3
- KEY FEATURES 3
- PACKING LIST 3
- PRODUCT INTERFACES 5
- PRODUCT INSTALLATION 7
- DISPLAY INTRODUCTION 8
- OPERATING GUIDENCE 9
- PARAMETERS 11
- FAQ 13
- WARNING 14
- SUPPORT 14

INTRODUCTION

Thank you for purchasing Hollyland LARK 150 wireless microphone. LARK 150 is the original dual-transmitters wireless microphone system made perfectly for 2-person mode content creation applications. Building on its wireless video transmission and intercom systems expertise, the LARK 150 is Hollyland's first 2.4 GHz digital wireless microphone system. Featuring an ultra-compact, clip-on design system, it offers an ever-reliable, professional sound quality that's ideal for vlogging, YouTube presentations, commercials, live streaming, and other video content.

KEY FEATURES

- 5ms Latency with up to 100m Range
- 2 TX & 1 RX Combo (or 1TX & 1RX Combo) Supported
- 2.4GHz Digital Wireless Transmission with Clear Sound Under Any Conditions
- Mini Size with Lightweight, 2 Colors Options
- Professional-Grade Sound Quality
- Built-In Lithium Batteries, with an Ultra Long Run Time
- 21-Stage Digital Gain Adjustment
- Contact Charging Case
- In-Built Mic and LavMic Switching Automatically
- Multiple Systems Using in One Location

PACKING LIST

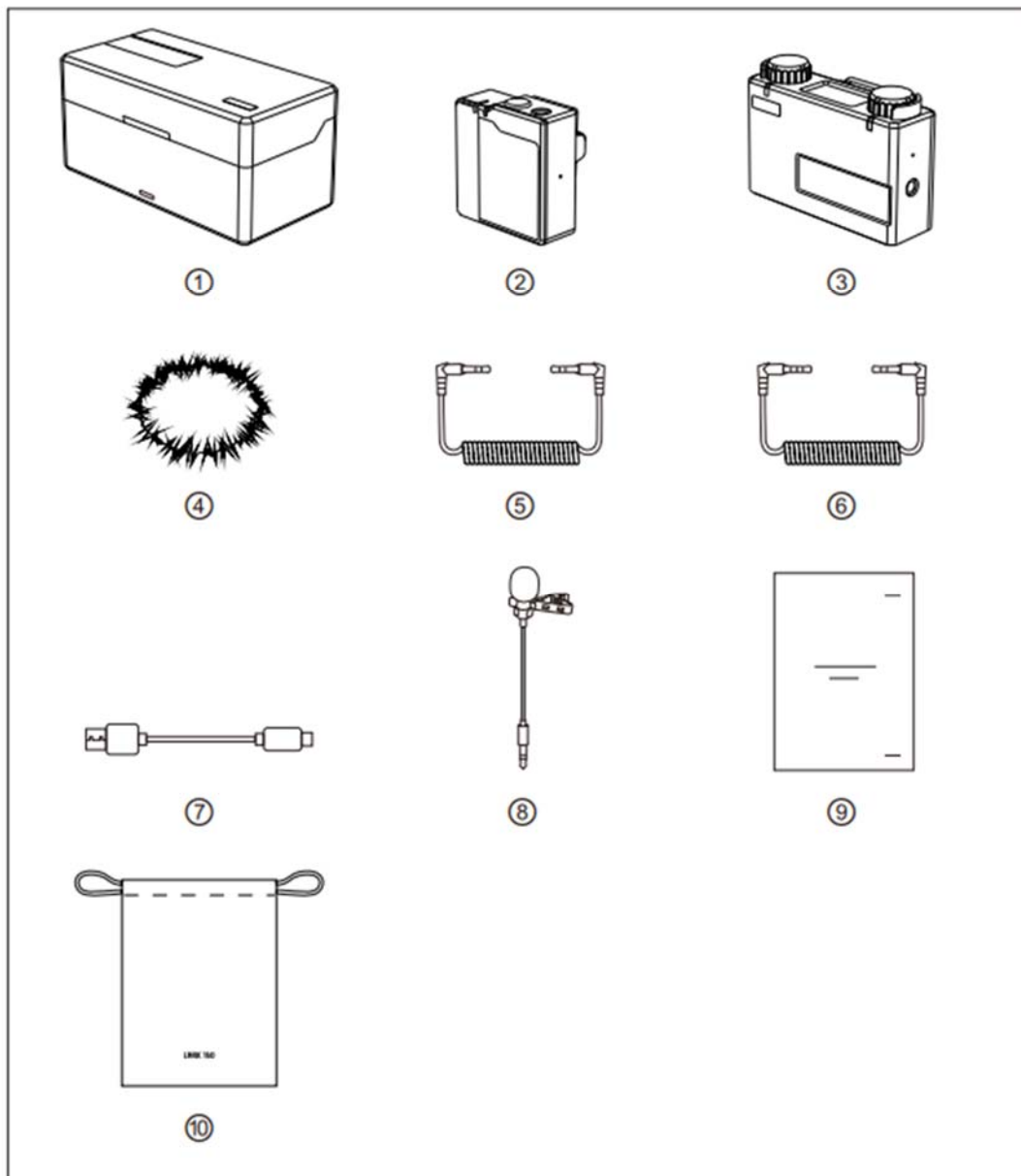

PACKING LIST OF TWO TRANSMITTERS AND ONE RECEIVER

①	Charging Case	X1
②	Transmitter	X2
③	Receiver	X1
④	Furry Windshield	X2
⑤	3.5mm TRS Patch Cable	X1
⑥	3.5mm TRS to TRRS Patch Cable	X1
⑦	Lavalier Microphone	X2
⑧	USB Type-A to Type-C Cable	X1
⑨	User Guide	X1
⑩	Storage Bag	X1

PACKING LIST OF ONE TRANSMITTER AND ONE RECEIVER (Lark 150 Solo)

①	Charging Case	X1
②	Transmitter	X1
③	Receiver	X1
④	Furry Windshield	X1
⑤	3.5mm TRS Patch Cable	X1
⑥	3.5mm TRS to TRRS Patch Cable	X1
⑦	Lavalier Microphone	X1
⑧	USB Type-A to Type-C Cable	X1
⑨	User Guide	X1
⑩	Storage Bag	X1

PRODUCT INTERFACES

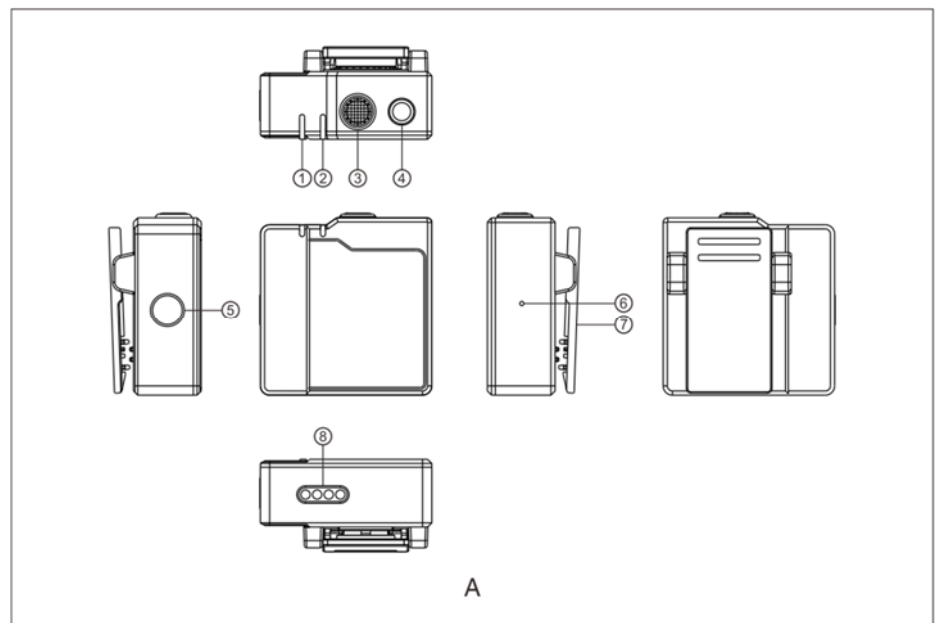

A: TRANSMITTER

- ① Power Indicator (Red: Low Battery, Green: Safe Battery Status, Orange: Charging)
- ② Link Indicator (Blue/Cyan Flashing: Disconnected, Blue/Cyan: Connected, Orange: MIC Mute)
- ③ In-built Microphone
- ④ 3.5mm Audio Input Port
- ⑤ Power Button (Press for 3s to Switch On/Off, Click to Mute)
- ⑥ Reset Button
- ⑦ Installed Belt Clip

⑧ Charging/Upgrade **Contact**

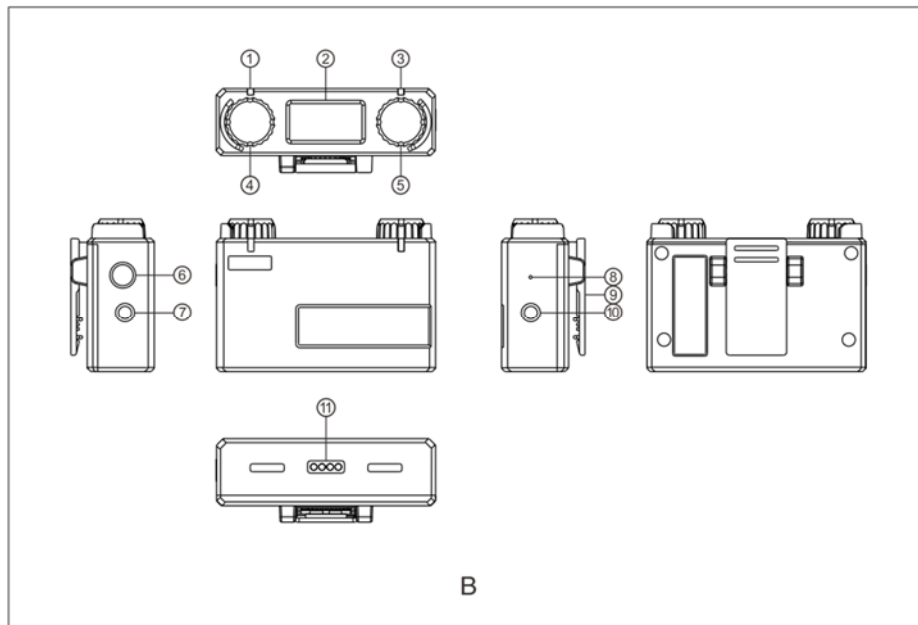

B: RECEIVER

- ① Link Indicator (Left Channel)
- ② Display Screen
- ③ Link Indicator(Right Channel)
- ④ Volume Knob (Left Channel) :Adjust the Volume of the Left TX
/Recording Mode Switch Button: Press to Switch the Recording Mode
/Left TX Mute Button: Click to Mute the Left TX
- ⑤ Volume Knob (Right Channel): Adjust the Volume of the Right TX
/Recording Mode Switch Button: Press to Switch the Recording Mode
/Right TX Mute Button: Click to Mute the Right TX
- ⑥ Power Button (Press for 3s to Switch On/Off)
- ⑦ 3.5mm Headphone Monitoring Port
- ⑧ Reset Button
- ⑨ Belt Clip
- ⑩ 3.5mm Audio Output Port
- ⑪ Charging/Upgrade Contact

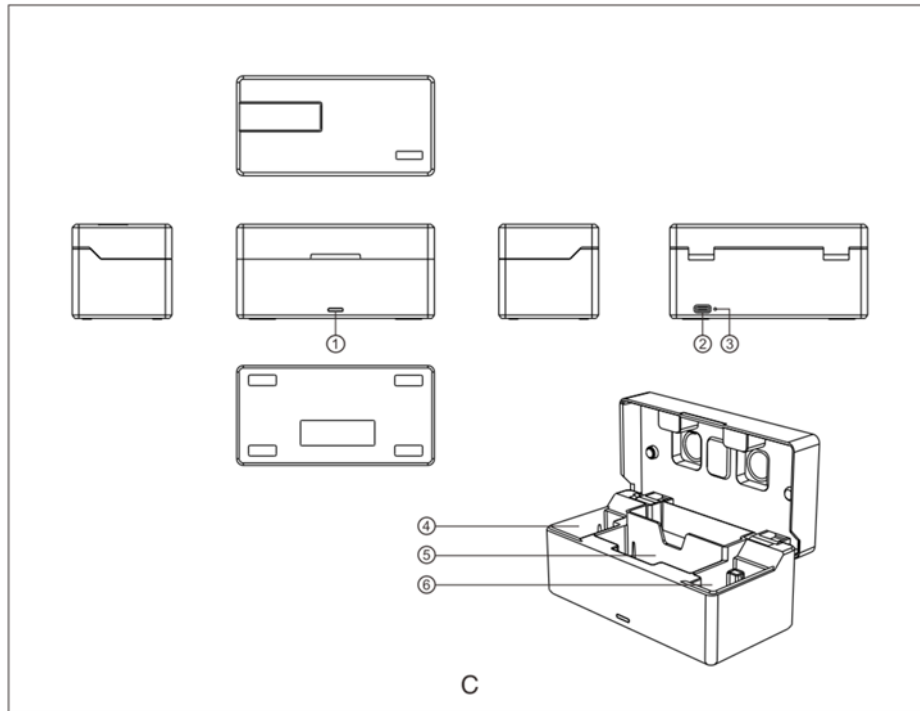

C: CHARGING CASE

- ① Power Indicator (Red: Low Battery, Green: Safe Battery Status, Orange: Charging)
- ② USB Type-C Port for Charging
- ③ Reset Button
- ④ TX Charging Slot
- ⑤ RX Charging Slot
- ⑥ TX Charging Slot

PRODUCT INSTALLATION

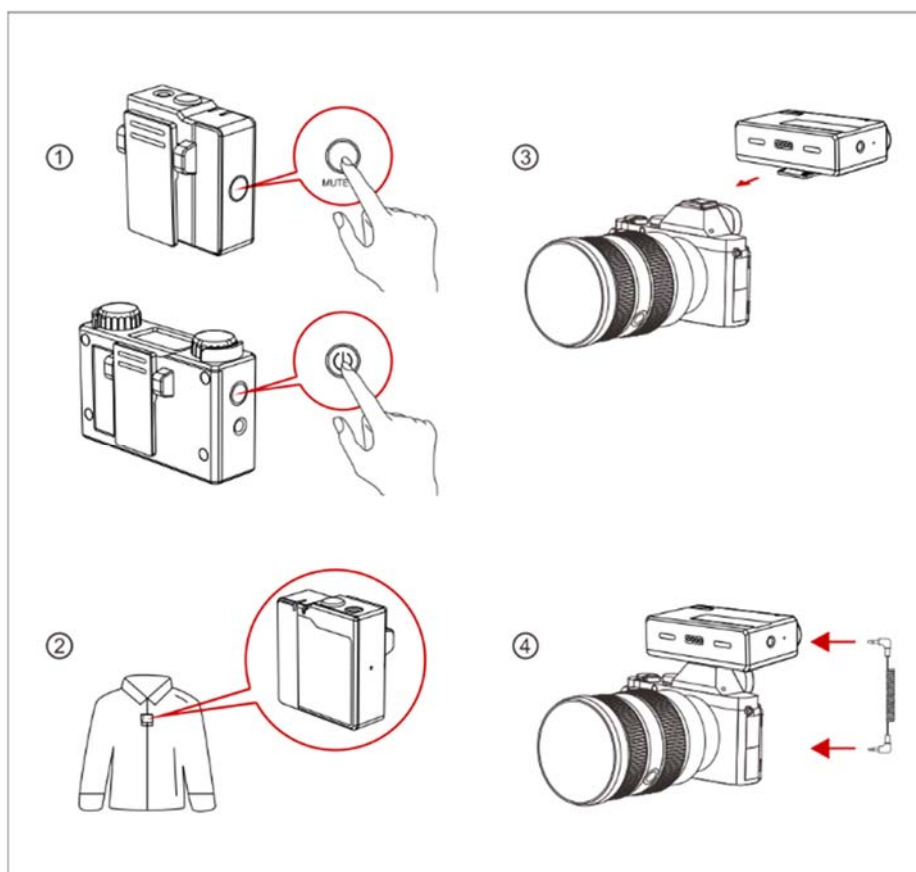

- ① Press Power Button of TX/RX for 3s to switch on.
- ② Install TX as Figure2.
- ③ Install RX on the Camera.
- ④ Connect the 3.5mm Audio output port of RX with 3.5mm Audio input port of the camera by 3.5mm TRS cable.
- ⑤ Set camera's recording volume to minimum and RX's output volume level in middle to ensure the best recording effect.

DISPLAY INTRODUCTION

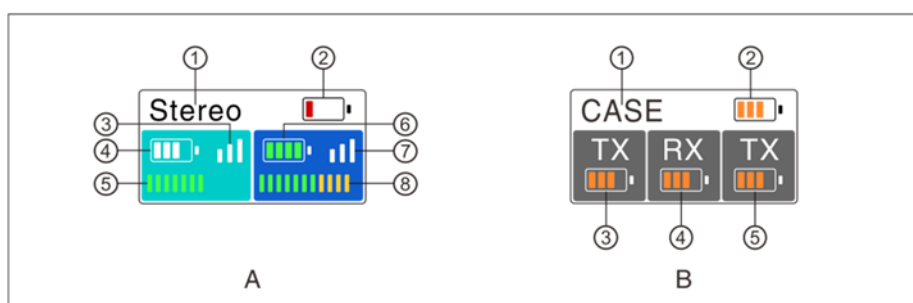

A: Display of RX

- ① Current Recording Mode of RX
- ② RX Battery Status

- ③ Cyan TX Signal Strength Status
- ④ Cyan TX Battery Status
- ⑤ Cyan TX Input Volume Status
- ⑥ Blue TX Battery Status
- ⑦ Blue TX Signal Strength Status
- ⑧ Blue TX Input Volume Status

The TX color displayed on main display screen of RX relates to the channel switch and recording mode, the indicators of RX represents the corresponding TX

B: DISPLAY OF RX CHARGING CASE

- ① Identification of Charging Case
- ② Charging Case Battery Status (Orange: Charging, Green: Full-Charged)
- ③ Left TX Battery Status (Orange: Charging, Green: Full-Charged)
- ④ RX Battery Status (Orange: Charging, Green: Full-Charged)
- ⑤ Right TX Battery Status (Orange: Charging, Green: Full-Charged)

OPERATING GUIDENCE

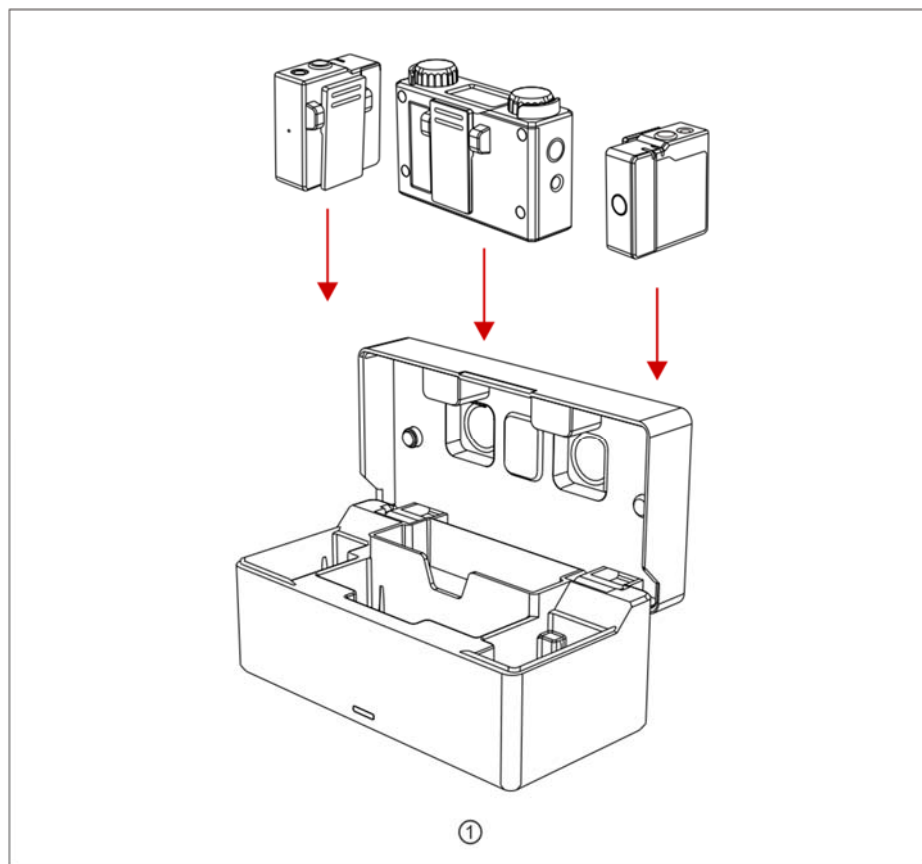

① PAIRING

1. Put TX and RX into the charging case at the same time, the unpaired devices will be paired automatically.
2. Display “√” when pair successfully.
3. Display “X” when pair failed.

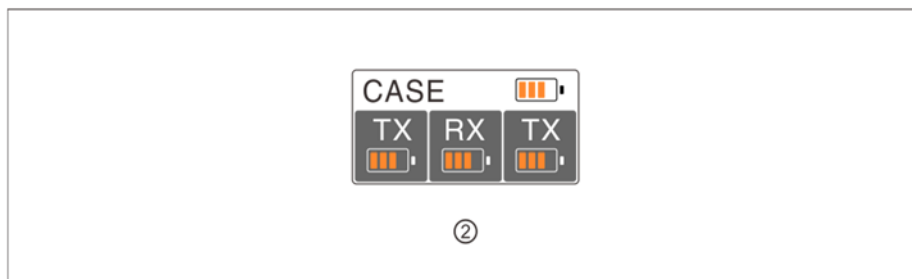

② CHARGING

1. It means low battery when the power indicator or the battery icon of RX display screen is red.
2. TX and RX will be charged when placed into charging case.
3. The indicator of TX will display orange when charging and go out after 15s. After placed into the charging case, TX, RX and charging case' s current battery status will be displayed on the screen of RX.
4. When TX and RX are fully charged, the devices will automatically enter sleep mode.
5. When taking out or putting in TX or TX, the device will automatically wake up and start up.
6. The indicator of charging case will display red and stop charging TX or RX when the battery energy is less than 10%.

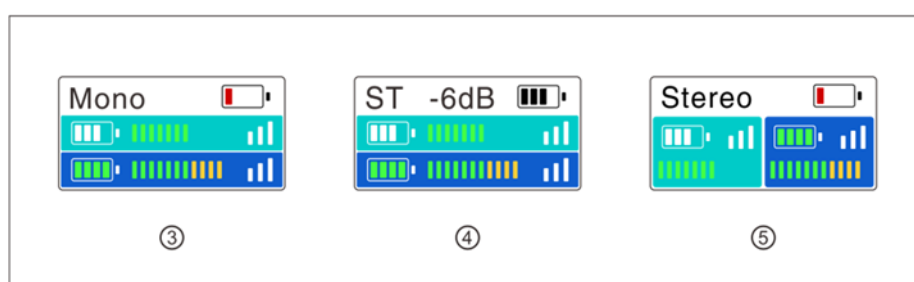

③ Mono Mode

1. After taking out, start up and successfully paired TX and RX.
2. Long press left button/right button for 3s to recording mode. Switch successful when the screen displayed “Mono” .
3. At this time RX switched to mono mode, both left and right channel outputs two audios of TX.

4. Volume of TX corresponds the indicator could be adjustable at this time by knob.

④ **Safety Track Mode**

1. After taking out, start up and successfully paired TX and RX.
2. Long press left button/right button for 3s to recording mode. Switch successful when the screen displayed “ST” .
3. At this time RX switched to ST mode, both left and right channels output two audios of TX, but the sound of right channel is 6dB less than left channel, in order to make sure one of the channels is in the safe output volume.
4. Volume of TX corresponds the indicator could be adjustable at this time by the knob.

⑤ **Stereo Mode (Supported by 2 TX and 1 RX Set)**

1. After taking out, start up and successfully paired TX and RX.
2. Long press left button/right button for 3s to recording mode. Switch successful when the screen displayed “Stereo” .
3. At this time RX switched to Stereo mode. Left side of display screen corresponds to left channel output, right side of display screen corresponds to right channel output.
4. Left knob controls output volume of left TX which corresponds left channel, right knob controls output volume of right TX which corresponds right channel.

⑥ **Auto Sleep Mode**

If TX and RX are not placed in the charging case and not connected, TX/RX will automatically enter low-power consumption sleep mode after 5 minutes without any action. Press the power button to awake and power on.

PARAMETERS

Interfaces	TX: 3.5mm Audio Input Port
------------	----------------------------

	Charging/Upgrading Contacts RX: 3.5 mm TRS Output Interface 3.5mm Headset Interface Charging/Upgrading Contacts Charging Case: USB Type-C Interface
Wireless Mode	Frequency :2.4GHz AFH Power: 10dBm MAX Modulation: GFSK
Built-In Mic	Polar Pattern: Omnidirectional Frequency Response: 20Hz~20KHz
Lavalier Mic	Polar Pattern: Omnidirectional Frequency Response: 20Hz~20KHz
Reference Audio Input Level	-65 dBV
Maximum Input Sound Pressure Level	100dB SPL (1KHz@1m)
Dynamic Range	100 dBA
Polar Pattern	Omnidirectional
Audio Output Level Change Range	21-State: 45dB
Transmission Latency	5ms
Battery Mode	TX: 200mAh (0.76Wh) RX: 530mAh (1.96Wh) Charging Case: 3350mAh (12.16Wh)
Battery Life	TX: 4h RX: 7.5h Charging Case: About 2.5 times (Charge 2 TX and 1 RX at the Same Time in Full Charged States)
Charging Time@25°C	TX: 45mins RX: 65mins Charging Case: 2.5h (Charge TX/RX first, then charge the charging case)
Firmware Upgrade Method	PC
Dimensions	TX: (L*W*H) 37*37*17.5mm RX: (L*W*H) 67*41*20.5mm Charging Case: (L*W*H) 121*61*43.5mm
Weight	TX: 20.5g RX: 51g Charging Case: 227.5g
Life Time	3 Years

FAQ

1. What are the different of three mode?

Mono mode: The audio output in RX has not relation with the right/left channel, the sound is a mixture of TX1 and TX2.

Stereo Mode: The audio output in RX is stereo, TX1 output left channel, TX2 output right channel, The sound in both channel is different.

Safe Audio Track Mode: For the audio output in RX, in the left channel, the audio is mix up of TX1 and TX2, in the right channel is TX2 minus 6dB add TX1.

2. What is the safe audio track mode function?

In the different cameras, the volume of the microphone input is different, if the volume exceeding a level, that will cause the audio broken, and the audio material can not be used (In the Post editing software, the low volume has a chance to turn up, but if the audio is broken, we have no way to repair it). The safe audio track mode provides a reliable guarantee, we can use the audio in the right channel to replace the damaged part of audio in the left channel by the post-editing software.

3. How long does the wireless microphone with full power can be used? How long will it take for the device to be fully charged?

TX: working time 4.5h, Fully charged for 1.2h

RX: working time 7.5h, Fully charged for 1.5h

Storage Box: charge 2.5 times for 2 TX add 1RX, Fully charged around 2.5h

The two transmitters can be used in turn, the device starts charging when you push it into the storage box.

4. How to check the surplus power on the charge box?

- The RX and TX will turn off and charge automatically when you push them into storage box.
- Pressing the knob of receiver, the surplus power of TX1/TX2/RX and storage box will display on the screen.

5. How to pair wireless microphone?

First, confirming the RX and TX are on, then the device will be pair automatically when you push both of them into the storage box.

6. How to upgrade wireless microphone?

Push both of RX and TX into storage box, then using Type-C cable to connect the device and computer.

WARNING

Do not place the devices in the accessories or inside of Heating Equipment, Cooking equipment, High-Pressure Containers, etc. (Such as Microwave Ovens, Induction Cookers, Electric Ovens, Electric Heaters, Pressure Cookers, Water Heaters, Gas Stoves, etc.) to prevent the battery from overheating and exploding. The Charger, data cable and battery of the original matching model must be used. Using chargers, data Cables, and batteries that are not certified by the manufacturer or of non-matching models may cause Electric Shock, Fire, Explosion, or Other Dangers.

SUPPORT

If encounter any problems in using the product or need any help, please help these ways to get more technical support: